

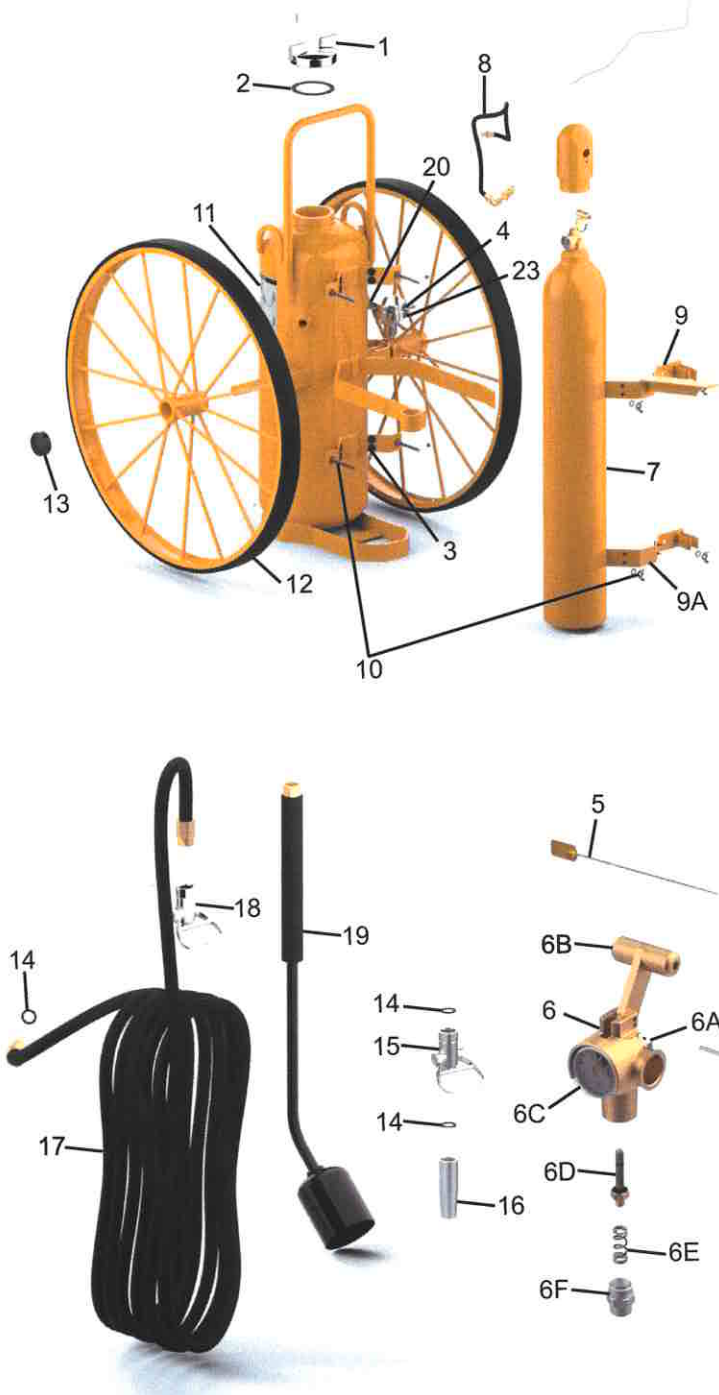

# PARTS LIST for 150/250 lb. Class D 110 CU. FT. Argon Cylinder Wheeled Extinguisher Models

680 - 150 lb. Sodium Chloride  
681 - 250 lb. Copper



ITEM NO.	PART NO.	DESCRIPTION
1	06993	Cap, Agent Cylinder
	12576	Cap, Agent Cylinder with Pressure Indicator
2	02272	Gasket, Cap
3	13958	Bumper, Rubber
4	10915	Argon Pressure Regulator
5	01387	Lock Wire Seal (Yellow)
6	12467	Argon Valve with Gauge ("T" Handle Quick Release)
6A	16516	Safety Disc, Gasket and Nut Assembly
6B	06373	Valve Lever ("T" Handle - Complete)
6C	10213	Gauge - 3000 PSI
6D	09897	Valve Stem Assembly
6E	00501	Spring
6F	09627	Retainer
7	10904	Argon Cylinder (110 cu. ft.) - Charged with Cap
8	02234	Argon Hose Assembly
9	10906	Retaining Strap with Hose Hanger
9A	11020	Retaining Strap (Bottom) - Argon Cylinder
10	16483	Bolt, Washer and Wing Nut
11	10910	Pictogram - 680, 681
12	10917	Wheel Assembly - 36" x 2 1/2" with Rubber Tread
13	16984	Hub Cap - 36" Wheels
	07389	Hub Cap, Washer and Pin - 36" Wheels
14	03877	Gasket, Hose/Nozzle
15	06279	Ball Valve Assembly
16	06467	Nozzle Tip (.312) (OPTIONAL)
17	10913	Hose Assembly - 3/4" x 25 ft.
18	06717	Ball Valve Assembly
19	09740	Wand Applicator Assembly
20	04523	1/4" SS Pipe Nipple
21	00532	Chain (Nylon) for Ring Pin
22	00160	Ring Pin Stainless Steel
23	04444	1/4" MXF Elbow



**800.321.3396**

**www.nascoop.com**